

Technical Bulletin # 661F

**Bulletin Description**

Cracking of concrete slabs and substrates is a common occurrence. Excessive tensile and compressive forces, freeze-thaw cycles, and incorrect water to cement mix ratios are common causes. One practice to repair cracks is to pressure inject thermosetting resin into them. This bulletin describes several techniques for repairing minor cracks in concrete foundations prior installing equipment.

**Repair Techniques**

The basic technique used to repair a crack starts with drilling a hole at each end of the crack. The holes should have a diameter that is wider than the crack. They will act as an injection point at one end and a vent point at the other. The holes will also relieve stress in the concrete and will help prevent the crack from spreading.

Additional holes should be drilled every 8 to 12 inches along the crack. As each hole is used as an injection point with the adjacent hole acting as the previous hole's vent. Zirc fittings or injection ports should be placed in the injection holes.

The fittings can be secured with either PHILLYBOND #6 or Repair Compound. The fittings or ports should allow a grease gun hose to screw onto the fitting.

Once the fill and vent points have been prepared, the exposed crack must be sealed. All loose or contaminated concrete in and around the crack must be removed by chiseling it out with a hammer and chisel. Once this step is completed, cover the top of the crack with either PHILLYBOND #6 or REPAIR COMPOUND. Use PHILLYBOND #6 if pressure injecting into the crack that day as it cures quickly. REPAIR COMPOUND requires overnight to cure. Once the material used to seal the crack has cured, pressure injection of a thermosetting resin liquid into the crack can commence.

Several resin systems can be used to fill cracks in concrete including CONCRETE ADHESIVE, PHILLYCLAD, 1775/620TS, CHOCKFAST RED LIQUIDS. Please see the individual product Technical Bulletins for details on unit size and coverage. CHOCKFAST Gray can also be used for to fill cracks greater than 1/8 inch in width.

Carefully mix the resin and hardener per manufacturer's instructions. Pour the mixed material into a clean grease gun or a fill-able caulking cartridge and begin pressure injecting at one end of the crack. Continue to inject resin until it begins to come out of the adjacent hole. Once resin appears in its hole inset a zirc fitting into it and continue injection into that hole. Continue this process the entire length of the crack.

Epoxy resin cures through an exothermic reaction. The resin will begin to generate heat once the curing cycle begins. If the grease gun or airless pump begins to become warm, immediately clean the equipment with a suitable solvent such as IMPAX IXT-59. Failing to do so may result in loss of equipment. When finished IMPAX IXT-59 can be used for general clean up.

**Reference**

For details on the epoxies mentioned above please request Bulletin No. 950 for PHILLYCLAD 1775/620TS, No. 1014 CONCRETE ADHESIVE, No. 1015 REPAIR COMPOUND or No. 964 PHILLYBOND #6.

**Date**

08/2005

**ITW POLYMER TECHNOLOGIES**

130 Commerce Drive • Montgomeryville, PA 18936 • 215-855-8450 • Fax 215-855-4688

[www.chockfastgrout.com](http://www.chockfastgrout.com) • [www.escoweld.com](http://www.escoweld.com)ITW Polymer Technologies  
Registered to ISO 9001:2000  
File No. A3790ITW Performance Polymers Europe  
ISO 9001:2000  
Q 05-020

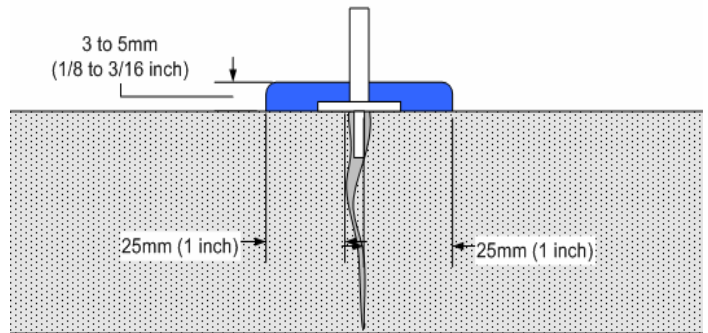
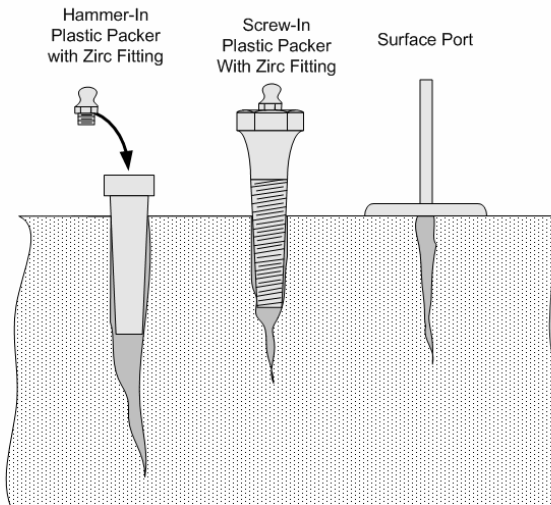

Porting Adapter Installed in a Crack

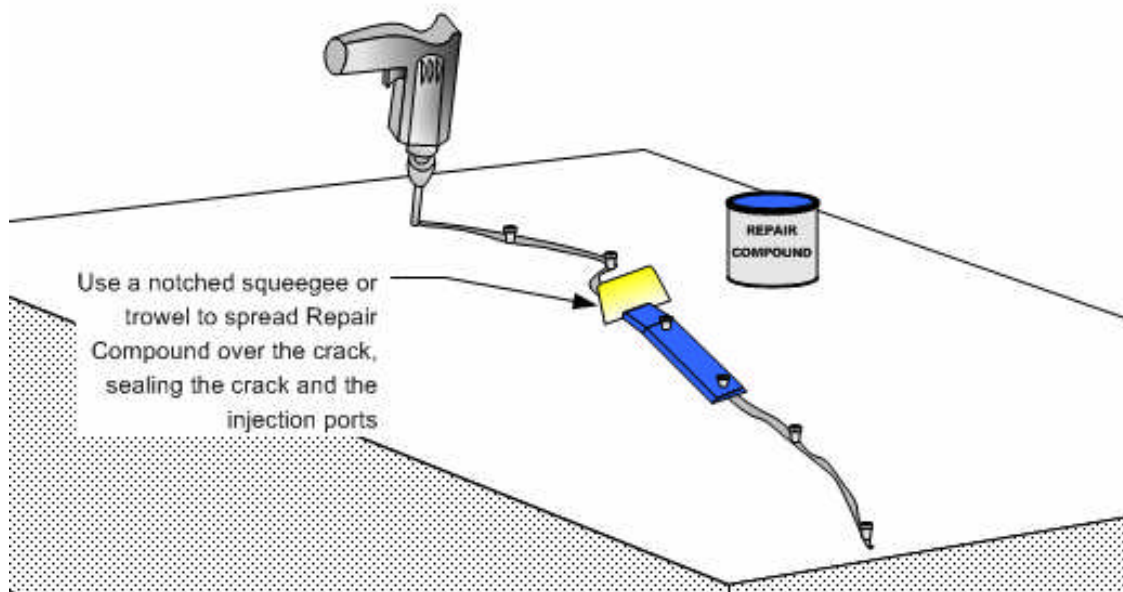

**General:** Every reasonable effort is made to insure the technical information and recommendations on these data pages are true and accurate to the best of our knowledge at the date of issuance. However, this information is subject to change without notice. Prior versions of this publication are invalid with the release of this version. Products and information are intended for use by qualified applicators that have the required background, technical knowledge, and equipment to perform said tasks in a satisfactory manner. Consult your local distributor for product availability, additional product information, and technical support.

**Warranty:** ITW Polymer Technologies, a division of Illinois Tool Works Inc., warrants that its products meet their printed specifications. This is the sole warranty. This warranty expires one year after product shipment.

**Warranty Claims:** If any product fails to meet the above, ITW Polymer Technologies will, at its option, either replace the product or refund the purchase price. ITW Polymer Technologies will have no other liability for breach of warranty, negligence, or otherwise. All warranty claims must be made in writing within one year of the date of shipment. No other claims will be considered.

**Disclaimer:** ITW Polymer Technologies makes no other warranty, expressed or implied, and specifically disclaims any warranty of merchantability or fitness for a particular purpose.

Suggestions concerning the use of products are not warranties. The purchaser assumes the responsibility for determining suitability of products and appropriate use. ITW Polymer Technologies' sole liability, for breach of warranty, negligence or otherwise, shall be the replacement of product or refund of the purchase price, at ITW Polymer Technologies' election. Under no circumstances shall ITW Polymer Technologies be liable for any indirect, incidental or consequential damages.

**Modification of Warranty:** No distributor or sales representative has the authority to change the above provisions. No change in the above provisions will be valid unless in writing and signed by an officer or the Technical Director of ITW Polymer Technologies. No term of any purchase order shall serve to modify any provision of this document.

**Mediation and Arbitration:** If any dispute arises relating to products or product warranties, either the purchaser or ITW Polymer Technologies may a) initiate mediation under the then current Center for Public Resources (CPR) Model Procedure for Mediation of Business Disputes, or b) initiate a non-binding arbitration under the rules of the American Arbitration Association for the resolution of commercial disputes.